

10306 Curley Rd, Dade City FL  
parcel ID: 14-25-20-0000-00300-0053

5 acre parcel

Site to have no public access. It is for workers to load materials and park vehicles at the end of the day.

Will have a security system/lights.

Need a well and septic



trees

carport installed on millings electrical in carport (lights)

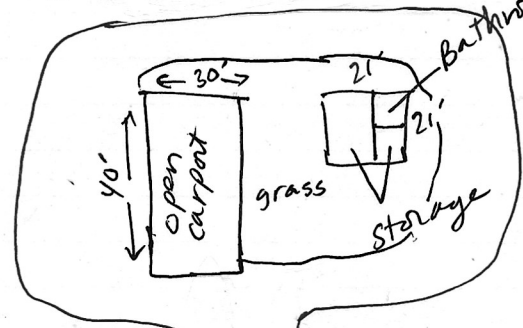

concrete block building with shingle roof single bathroom

Open pasture

Open pasture

225'

12'

asphalt millings 6" deep

gate

fence

Curley Rd